



Welcome

PORTRAIT PHOTOGRAPHY



Albert Tsai

Albert Tsai Photography

www.alberttsaiphoto.com

albert@alberttsaiphotography.com

Portrait Photography

- **History of Portrait Photography**
- **Equipment selection**
- **Portrait Photography with Continuous Light**
- **Portrait Photography with Flash**



The First Portrait Photograph Ever Made

In 1839, a year after [the first photo containing a human being](#) was made, photography pioneer [Robert Cornelius](#) made the first ever portrait of a human being.



Daguerreotype Process



Portrait with Continuous/Natural Light

- A 5 in 1 Reflector with an assistant or a partner



- ColourChecker Passport Photo 2
- ThinkTank Airport International V2.0 Roller



Portrait Photography Basics

- Most people photos are photographed at around +1/2 or +1/3.
- Beauty, 1/2 to 2/3, Photographed at low f-stop ie f1.4.
- Increase contrast to use the whole histogram.
- Angles are such that the nose appears smaller than it is
- Eyes are even.
- Character type photography, shoot normal, show as much detail on the face as possible, shoot at a higher f-stop.
- Beauty shoot focus at the closest eye to the camera and throw the rest of the face out of focus, using lower f-stop
- When working in really uneven light, expose for the highlights and make sure they are not blown out
- Photos need detail in the blacks and the whites. If none exist, there is too much contrast. Such a print would score low in a competition.

Photographic Portrait with Continuous Light

Colour Basic-Analogous Colour/Complementary Colour

Analogous Colour- colours are groups of three colours that are next to each other on the colour wheel

Camera: Nikon D810

Lens: 85mm f1.4

ISO 64

Aperture :f/1.4

Speed: 1/125 sec



Colour Basic-Analogous Colour/Complementary Colour

Complementary colours are opposite to each other on the colour wheel

Camera: Leica M240
Lens: Leica 75mm f1.25
ISO 800
Aperture :f/2.4
Speed: 1/180 sec



The Golden ratio

Camera: Leica M2400

Lens: Leica 75mm f1.25

ISO 100

Aperture: f/2.0

Speed: 1/360 sec

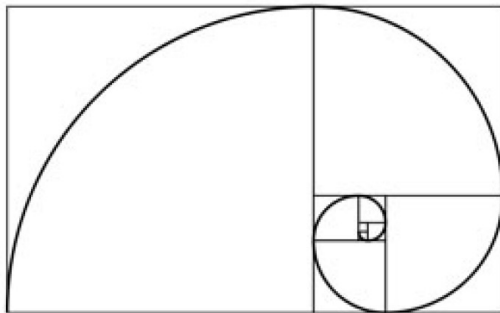

Defused Soft Light

Camera: Leica SL2

Lens: Leica 75mm f1.25

ISO 500

Aperture :f/1.25

Speed: 1/160 sec



White Balance adjustment

Camera: Leica M240

Lens: Leica 75mm f1.25

ISO 640

Aperture :f/1.25

Speed: 1/160 sec



Creative with Colour Filter

Camera: Leica M240

Lens: Leica 50mm f1.0

ISO 800

Aperture :f/2.4

Speed: 1/180 sec



Photographic Portrait with Flash

Thought The Len, light is measured by camera

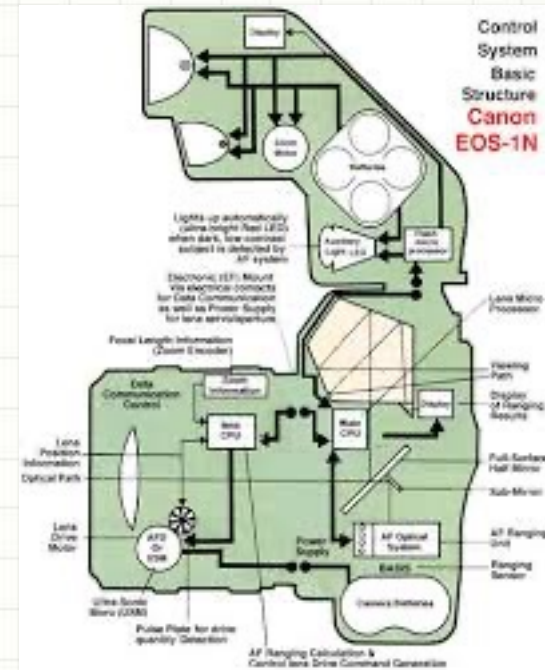

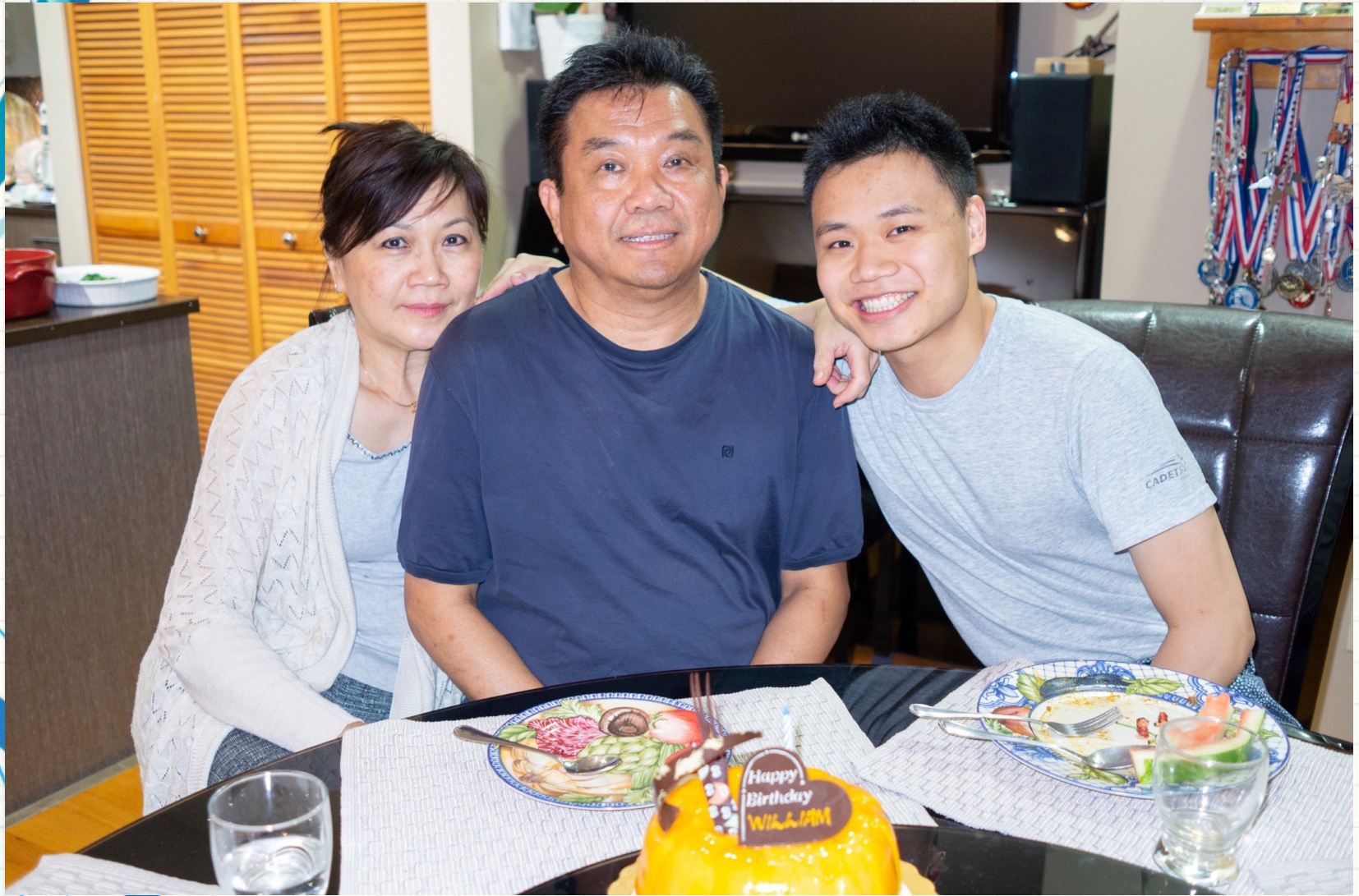

ISO800; 1/30 sec; f/2.8 @35mm with Camera Flash on direct



ISO800; 1/30 sec; f/5.6 @35mm with Camera Flash on direct



ISO100; 1/80 sec; f/5.6 @24mm with on Camera Flash on direct

Remote flash

A flash used off camera triggered by a radio or light signal



Nikon D810, Zeiss 85mm
ISO 100; f/8; 1/200 sec
Shoot with two strobes





Nikon D850;ISO400; 1/3200 sec; f/2.8 @24mm
with off Camera Flash X 3 diffused by an umbrella

Posing and Prop

Camera: Nikon D810

Lens: Zeiss Otus 85 f1.4

ISO 500

Aperture :f/1.4

Speed: 1/100 sec



**Nikon D810, Zeiss 85mm
ISO 200; f/13; 1/200 sec
Shoot with two strobes**



High Speed synch

photographing above the regular synch speed, and still properly synchronizing with a Speedlight.

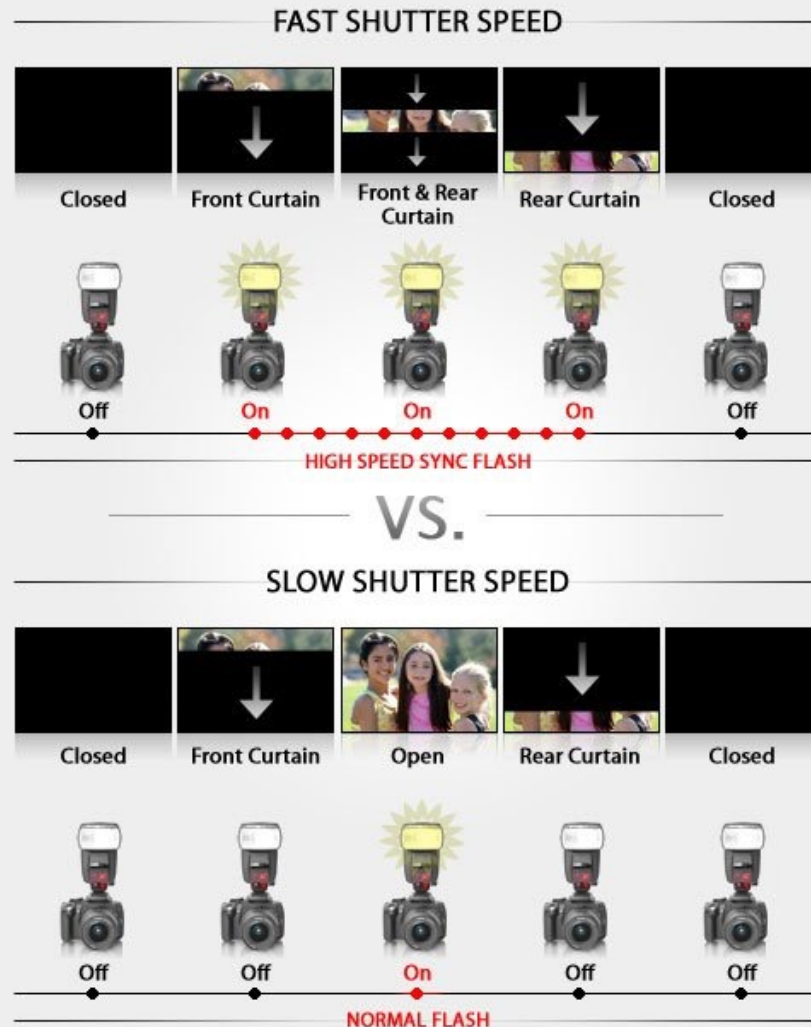



1/250sec f2.0 ISO100 Flash on



1/1000sec f2.0 ISO100 High Speed Flash on



1/2000sec; f2.0; ISO200; no flash



**1/8000sec; f4.0; ISO200;
High Speed Flash flash on**



ISO200; f/2.5; 1/2500; Off camera flash



1/5000sec f1.6 ISO400 @55mm with remote Flash



ISO200; f1.4; 1/5000sec; Off Camera Flash

Bounce Flash

point the flash at a surface (ceiling or wall) which create indirect light source and soft light





ISO1000; 1/50 sec; f/8.0 @24mm with on Camera Flash on bounce



Adding Filter on Flash

Light Source	Color Temperatures
Candles	1800 K
Incandescent Bulb	3000 K
Fluorescent Bulb	3000 K
Sunrise Daylight	3000 K
Moonlight	4000 K
LED Bulb	5000 K
Daylight	6000 K
Flash	6000 K
Overcast Daylight	6500 K

Figure 3-20: Common color temperatures, measured in Kelvin.



Incandescent Filter
CTO Filter



Fluorescent Filter
CTG Filter

Nikon D850+24-70mm
1/60sec f5 24mm
With Incandescent Filter



Use diffuser and Colour Filter with Flash

Camera: Nikon D850,
Lens: Nikon 24-70mm
ISO 1600; f/5.6; 1/40 sec
Shoot with two strobes + filter





THANK YOU!



QUESTIONS?